



Client _____ Quantity _____
 Project _____ Position _____

FUN 700

Model: F70/70CFGB

Cod: MP01032113000

Technical data

| | |
|------------------------------|--------------|
| Modularity: | Gas oven |
| Dimension (mm): | 700x700x850 |
| Oven dimension (mm): | 555x540x270 |
| Total gas power (Kcal/h): | 20121 |
| Total gas power (kW): | 23,4 |
| Oven type: | Static oven |
| Oven power (kW): | 5 |
| Oven temperature range (°C): | 150-300 |
| Gas connection: | 1/2" |
| Net volume (m3): | 0,417 |
| Packing dimensions (mm): | 776x776x1180 |
| Gross weight (kg): | 95 |
| Burner power 1 (kW): | 5,5 |
| Burner power 2 (kW): | 3,7 |
| Burner power 3 (kW): | 5,5 |
| Burner power 4 (kW): | 3,7 |
| Gross volume (m3): | 0,711 |

Features

| | |
|--------------|------------------------------------------------------------------------------------------------------------|
| Burners: | Double or single crown cast iron version available with a pilot light |
| Grill: | Cast-iron with brass single- and double-crown burner with pilot |
| Working top: | Made of AISI 304 stainless steel with a thickness of 10/10 mm and removable enamelled containers |
| Knobs: | Knobs are made from a sturdy heat-resistant polymer blend and are equipped with liquid anti-leakage washer |
| Handles: | Brushed aluminum finish |
| Kit Gas: | Natural gas conversion kit 30/50 m/bar (tested with natural gas G20) |

Technical draw

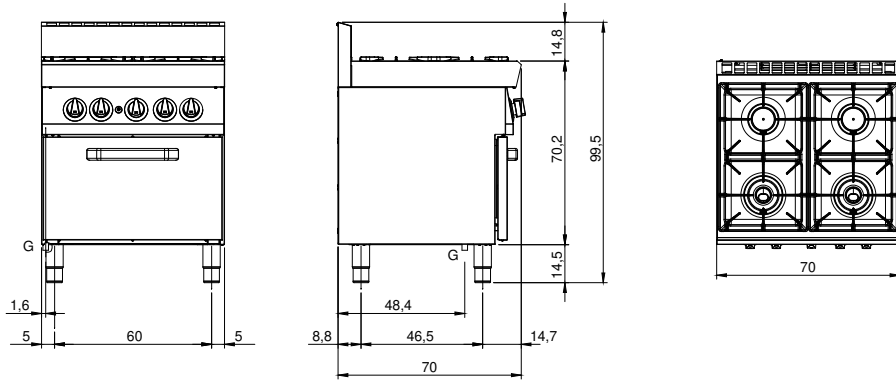

G: Gas connection 1/2"