

Client \_\_\_\_\_ Quantity \_\_\_\_\_  
 Project \_\_\_\_\_ Position \_\_\_\_\_

## FUN 650

Model: F65/70TPG/T

Cod: MP01052112000



### Technical data

Modularity:	Top
Dimension (mm):	700x650x300
Total gas power (Kcal/h):	7739
Total gas power (kW):	9
Whole-plate power gas (kW):	8,2
Gas connection:	1/2"
Net volume (m3):	0,137
Packing dimensions (mm):	776x776x636
Gross weight (kg):	60
Gross volume (m3):	0,383

### Features

Grill:	In cast iron with long spokes
Working top:	Made of AISI 304 stainless steel with a thickness of 10/10 mm
Knobs:	Knobs are made from a sturdy heat-resistant polymer blend and are equipped with liquid anti-leakage washer
Kit Gas:	Natural gas conversion kit 30/50 m/bar (tested with natural gas G20)

Gas solid top range. Top made of AISI 304 stainless steel thickness 8/10; covering in AISI 430 stainless steel thickness 8/10; bottoms and internal parts in AISI 430 steel; internal reinforcements made of anti-corrosion material (aluminised sheet metal). Gas full plate dimensions 66x54 cm. High-performance plate equipped with extractable central ring. High-power cast iron burner (1x8.2 kW). Safety gas valve cock with thermocouple. Piezoelectric ignition. Total power 8.2 kW

**Technical draw**

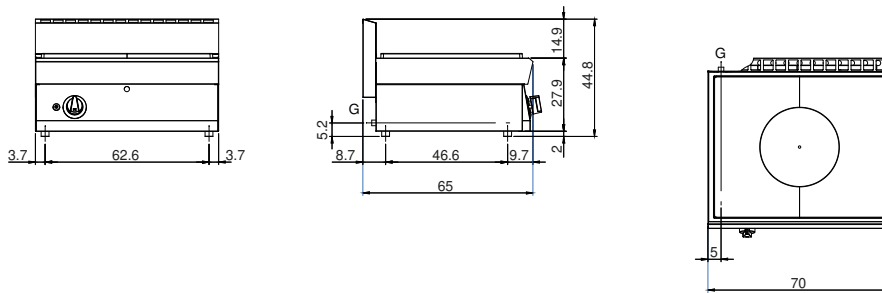

G: Gas connection 1/2"