



Client _____ Quantity _____
Project _____ Position _____

ROC 700

Model: R70/80FTE/LR/P
Market: Extra UE

Cod: MP01374123021

Technical data

| | |
|-------------------------------------|-----------------------|
| Modularity: | On cabinet with doors |
| Dimension (mm): | 800x730x870 |
| Total electric power (kW): | 10,8 |
| Cooking zone dimensions 1 (LxD mm): | 735x530 |
| Electric power (V): | 380-415 |
| Ampere (A): | 16,5 |
| Phases: | 3N |
| Cable section (mmq): | 5G2,5 |
| Frequency (Hz): | 50-60 |
| Net volume (m3): | 0,508 |
| Packing dimensions (mm): | 880x856x1109 |
| Gross weight (kg): | 109 |
| Gross volume (m3): | 0,835 |

Features

| | |
|------------------------------|--|
| Working top: | Made of AISI 304 stainless steel with a thickness of 20/10 mm |
| Material of plate: | Mild steel |
| Knobs: | Made of aluminum with IPX5 water protection |
| Handles: | The brushed aluminum handles allow for a secure and sturdy grip with a ergonomic lines |
| Flue: | Removable gas exhaust flue grill made of cast iron |
| Liquid collection container: | Estraibile e lavabile in lavastoviglie |
| Plate: | In mild steel |
| Upright Splash guard: | On two sides (optional) |

Electric griddle with 2/3 Smooth 1/3 grooved plate, model on counter with doors. Side panels, bottom and back made in stainless steel. Top made in AISI 304 thickness 20/10. Rear flue made in enamelled cast-iron. designed for flush alignment. Recessed (4 cm) hotplate fully welded and sealed to the top. Satin cooking surface with cold zone at the front. Round hole and extractable drawer for grease drain and collection. Plate dim.735x530 mm. Two independent cooking zones. Heating by means of "Incoloy 800" armored heating elements. Temperature control by means of thermostat. Safety thermostat. Lamp on control panel to indicate heating activation. Special design knobs to avoid water penetration in the control panel. Base completely made in stainless steel. Presses hinged doors Ergonomic handles. Adjustable feet made in stainless steel. IPX4 protection rating. Electric power supply VAC 400 3N 50÷60 Hz - 10.8 kW.

Technical draw

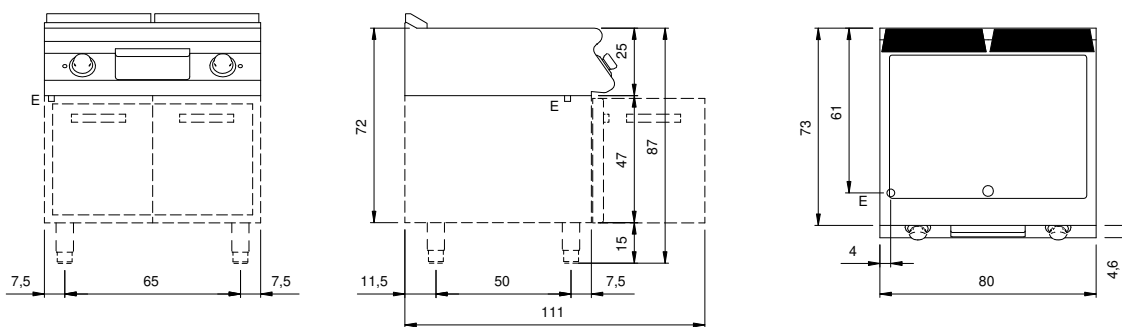

E: Electric power