



Client  
Quantity  
Project  
Position

## FUN 650

Model:  
F65/40PLC/T  
Cod:  
MP01732142000

### Technical data

Modularity:  
Top  
Dimension (mm):  
400x650x300  
Net volume (m3):  
0,078  
Packing dimensions (mm):  
477x776x612  
Gross weight (kg):  
19  
Gross volume (m3):  
0,227

### Features

Working top:  
Made of AISI 304 stainless steel with a thickness of 10/10 mm  
Guide cassetti:  
Full extension

In order to constantly offer the best possible products we reserve the right to make changes on technical specifications without incurring any obligation for equipment previously or subsequently sold.

**Modular Professional S.r.l.** Via Palù, 93 - 31020 - San Vendemiano (TV) - Italy - P.I. 04414900268  
**modular@modular.it**

**modular.it** -

Neutral element with drawer, top  
Neutral work top with drawer Top in AISI 304 stainless steel thickness 8/10; covering in AISI 430 stainless steel 8/10; bottoms and internal parts in AISI 430 steel; internal reinforcements made of anti-corrosion material. (aluminised sheet metal). Equipped with stainless steel drawer mounted on runners, can be removed for cleaning and is suitable for insertion of GN bowls up to h. 150 mm.

### Technical draw

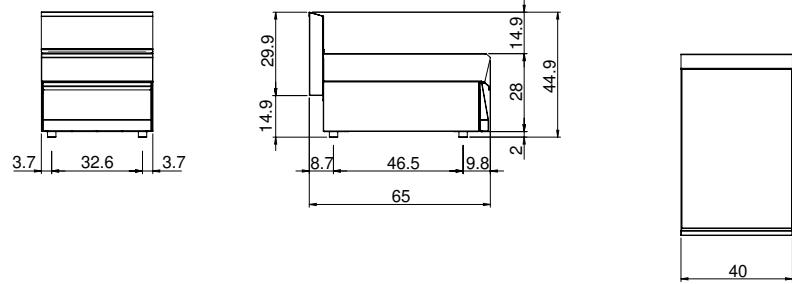

In order to constantly offer the best possible products we reserve the right to make changes on technical specifications without incurring any obligation for equipment previously or subsequently sold.

**Modular Professional S.r.l.** Via Palù, 93 - 31020 - San Vendemiano (TV) - Italy - P.I. 04414900268  
**modular@modular.it**

**modular.it** -